

1



Check the level of detergent and rinse aid.

2



Check that the filter, plug and arms (upper and lower) are installed correctly.

3



Press the button  to start the dishwasher.

4

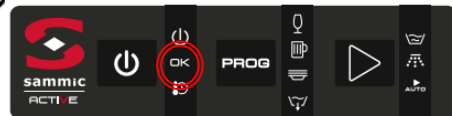

Wait 30 minutes until the wash temperature reaches 55°C. The "OK" icon will illuminate when the machine is ready to operate.

5



Remove the dishes and pre-wash them in the tap spray before putting them in the dishwasher.

6

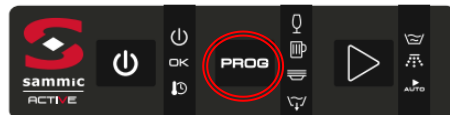

Select the most suitable wash program by pressing the "PROG" button.

7

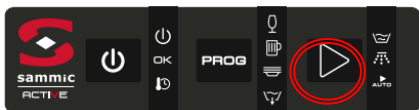

Press the button  to start the wash cycle. The machine will carry out the washing and rinsing processes automatically.

8

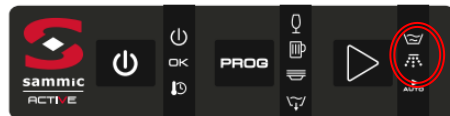

When the wash cycle is finished, both icons and flash simultaneously.

ACTIVE

AFTER USE OF THE MACHINE



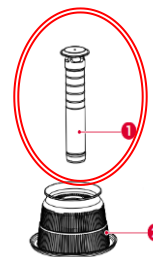

1

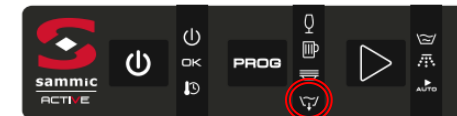

Remove the drain plug from the machine (on machines with a drain pump).

2



Press the button  to empty the tank (on machines with a drain pump). This process will take you 40 seconds.

3

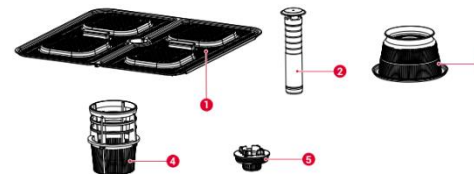

Remove the filters from the top and wash the internal parts of the machine.

4



Press the button  to turn off the machine.

HOW TO CLEAN THE WASH ARMS

Clean the wash arms every day! There are 2 arms: an upper and lower arm.

