



GLASSWASHER UX-40 ISO

Rack size 400x400mm and door clearance 300 mm. Double-skinned construction.



WARE WASHING
COMMERCIAL GLASSWASHERS



SALES DESCRIPTION

Sani-Control: guaranteed disinfection.
Embedded bodywork and easy-grip door: hygienic and ergonomic.
Double-walled body: insulation and energy efficiency.
Exclusive Hydroblade™ washing arms: maximum effectiveness.
3-stage filtering system.
Cold rinse function.

Sani-Control guarantee

- ✓ GUARANTEED DISINFECTION in compliance with standard DIN 10534.
- ✓ THERMAL LOCK function: Ensures that rinsing will be carried out at the ideal temperature to disinfect the dishes.

New recessed bodywork

- ✓ Ergonomic design with rounded corners to prevent the accumulation of dirt and facilitate cleaning.
- ✓ Compact tank volume (50% water saving compared to the previous range).
- ✓ Embedded basket guides.

Double-Walled (Ultra ISO)

- ✓ Double-Walled Structure: thermo-acoustic insulation to attenuate the sound level and improve energy efficiency.

Hydroblade™ washing arms

- ✓ Redesigned nozzles for greater washing performance.
- ✓ The “monoblock” design delivers durability and resistance to impacts.
- ✓ 30% savings in water consumption during rinsing compared to the previous range.

3-stage filter system: surface, tank and extraction

- ✓ Keeps the washing water in optimal conditions to maintain constant

washing performance.

- ✓ The surface filters feature an “easy-on” design and can be quickly removed without having to disconnect the washing arms.

“Easy grip” door: new design with integrated door handle

- ✓ The integration of the components provides greater resistance and robustness.
- ✓ Designed to have no corners or areas that are difficult to access: prevents deposits of dirt and facilitates cleaning.
- ✓ Its ergonomic handle provides a perfect grip, even with wet hands.
- ✓ Double-walled door with safety microswitch and high quality seal.
- ✓ 30 cm load capacity: high versatility for washing a wide range of glasses and even medium-sized dishes.

Premium warewashing

- ✓ Ultra Xperience: high performance, without complications.
- ✓ Soft start: progressive start-up of the washing pump to protect fragile items.
- ✓ Colour LCD Display: intuitive communication of the machine status by means of messages, colour codes and icons.
- ✓ Dedicated cycles: selection of the ideal washing programme using icons.
- ✓ Adaptable: allows the main parameters of the machine to be adjusted to the needs of each user.
- ✓ TEMPERATURE DISPLAY.
- ✓ Wash Plus+ function: increases the intensity of the wash cycle for greater cleaning performance.
- ✓ Control panel with IP65 humidity protection.

You will never WASH ALONE

- ✓ Tech Services: our team of technicians will help you so that your machine is always ready for use.
- ✓ Design Services: tell us what your needs are and we will advise you.
- ✓ 60 years of experience and know-how at your disposal.

INCLUDES

- ✓ Rinse aid pump.
- ✓ 1 glasses basket.
- ✓ 1 mixed basket (plates).
- ✓ 1 small basket for cutlery.

OPTIONAL

- ☐ Detergent dosing kit.
- ☐ Drainage pump with level sensor. Proactive tank water renewal.
- ☐ Manual resin regeneration water softener.
- ☐ Double-level accessory for washing two baskets at the same time.

ACCESSORIES

- ☐ Manual water softeners
- ☐ Automatic water softeners
- ☐ 400 x 400 mm baskets
- ☐ Inserts & supplements
- ☐ High feet kit
- ☐ Reverse osmosis devices
- OS-140
- ☐ Dosing equipments front AX / UX glass- and undercounter dishwashers
- ☐ Stand for 400 x 400 mm glasswashers
- ☐ Double rack kits for AX/UX

SPECIFICATIONS

Basket dimensions: 400 mm x 400 mm
Useful height: 300 mm



product sheet
updated 03/04/2025



GLASSWASHER UX-40 ISO

Rack size 400x400mm and door clearance 300 mm. Double-skinned construction.



Cycle duration: 90 / 120 / 150 / 180"
Production baskets / hour: 40 / 30 / 24 / 20
Boiler capacity: 4.5 l
Wash tank capacity: 9 l

Consumption and savings

Water consumption/cycle: 1.9 l
Automatic saving mode in: 25'
Automatic switch-off: 120'

Energy consumption

Water consumption/cycle (kWh): 0,15 kWh
Tank filling consumption (kWh): 0,39 kWh

Loading

- ✓ Pump: 250 W / 0.33 Hp
- ✓ Tank: 1200 W
- ✓ Boiler: 2800 W
- ✓ Total loading: 3050 W

External dimensions (W x D x H)

- ✓ Width: 490 mm

- ✓ Depth: 540 mm
 - ✓ Height: 710 mm
- Noise level (1m.): 60 dB(A)
Crated dimensions
525 x 615 x 820 mm
Gross weight: 46 kg

AVAILABLE MODELS

1303130	UX-40S 230/50/1
1303131	UX-40S 220/60/1
1303134	UX-40SB 230/50/1
1303138	UX-40SD 230/50/1
1303142	UX-40SBD 230/50/1
1303143	Glasswasher UX-40SBD 220/60/1

* Ask for special versions availability

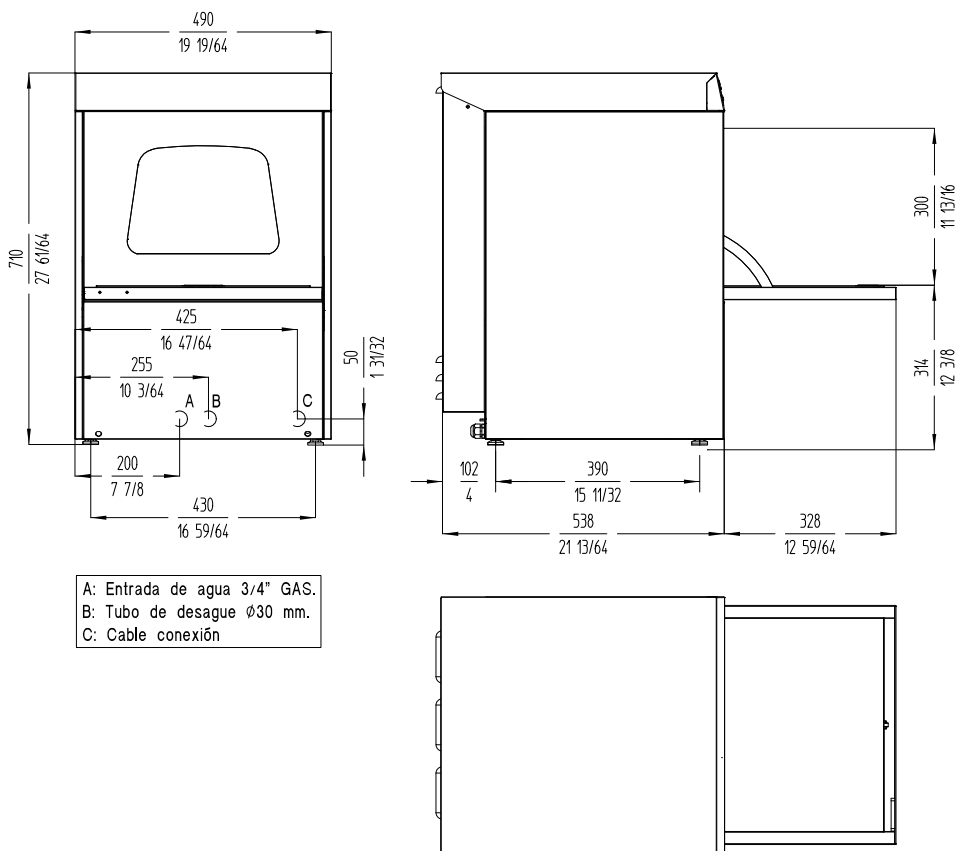

A: Entrada de agua 3/4" GAS.
B: Tubo de desagüe Ø30 mm.
C: Cable conexión

WARE WASHING
COMMERCIAL GLASSWASHERS

sammic | sammic.asia
Food Service Equipment Manufacturer

asia@sammic.com
phone: +65 67480511
3018 Ubi Road 1
408710 SINGAPORE

vietnam@sammic.com
phone: +84 (0) 862493814

thailand@sammic.com
phone: +66 (0) 993425561



Project

Date

Item

Qty

Approved

product sheet
updated 03/04/2025