



# HAND BLENDER XM-21

Professional immersion blender. 300 W.



DYNAMIC PREPARATION  
COMMERCIAL HAND BLENDERS



## SALES DESCRIPTION

- ✓ Variable speed motor block.
- ✓ 250 mm detachable arm.
- ✓ Designed for continuous use in recipients of up to 12 l.

### All-in-one

- ✓ Professional hand blender designed for carrying out different preparations without the need for add-on tools.
- ✓ Professional Y-blade, made from tempered steel and with a long-duration cutting edge.
- ✓ Vario-speed: variable speed.
- ✓ Smooth Control: smart speed control. The new SmoothControl system provides a faster response and better stability to the machine. It also improves the start-up under load and limits over-acceleration when removing the machine and in no-load situations.
- ✓ Designed to work in recipients of up to 12 litres.

### Maximum comfort for the user

- ✓ Compact design: logical and manageable size.
- ✓ Ergo-design & bi-mat-grip: external casing made in two materials for an ergonomic hold. Anti-slip grip. Optimum inclination of handle, minimising fatigue.
- ✓ Click-on-arm: detachable arm with fast and secure closure.
- ✓ Hood designed to avoid splashes.
- ✓ Intuitive use: very simple operation. Warning light when the machine is connected to the mains.

### Built to last

- ✓ Professional performance: capable of carrying out prolonged work without the casing overheating.
- ✓ Life-plus: equipped with a motor which has passed all of the most demanding usage tests.
- ✓ Studied geometry: casing designed to avoid rolling and falling.
- ✓ Ultra-durable arms designed to stand high temperatures in opera-

tion.

- ✓ Easy to clean: detachable, dishwasher safe arm.
- ✓ Approved by NSF: guaranteed safety and hygiene.

## INCLUDES

- ✓ Variable speed motor block.
- ✓ Wall mount.
- ✓ MA-21 mixer arm.

## OPTIONAL

- MA-22 mixer arm.
- Whisk BA-20.

## ACCESSORIES

- Motor unit MM-20V
- Whisk BA-20
- Mixer arms MA-20

## SPECIFICATIONS

Total loading: 300 W  
Maximum recipient capacity: 12 l  
Maximum working depth: 169 mm  
Motor speed: 1500 - 15000 rpm  
Blade diameter: 50 mm  
Blade guard diameter: 82 mm

### Length

Liquidising arm length: 250 mm  
Total length: 514 mm

Net weight: 2.31 kg  
Noise level (1m.): <80 dB(A)

Crated dimensions  
440 x 375 x 105 mm  
Gross weight: 2.91 kg

## AVAILABLE MODELS

3030625 Immersion blender XM-21 230/50-60/1

\* Ask for special versions availability



product sheet  
updated 03/02/2025



# HAND BLENDER XM-21

Professional immersion blender. 300 W.



DYNAMIC PREPARATION  
COMMERCIAL HAND BLENDERS

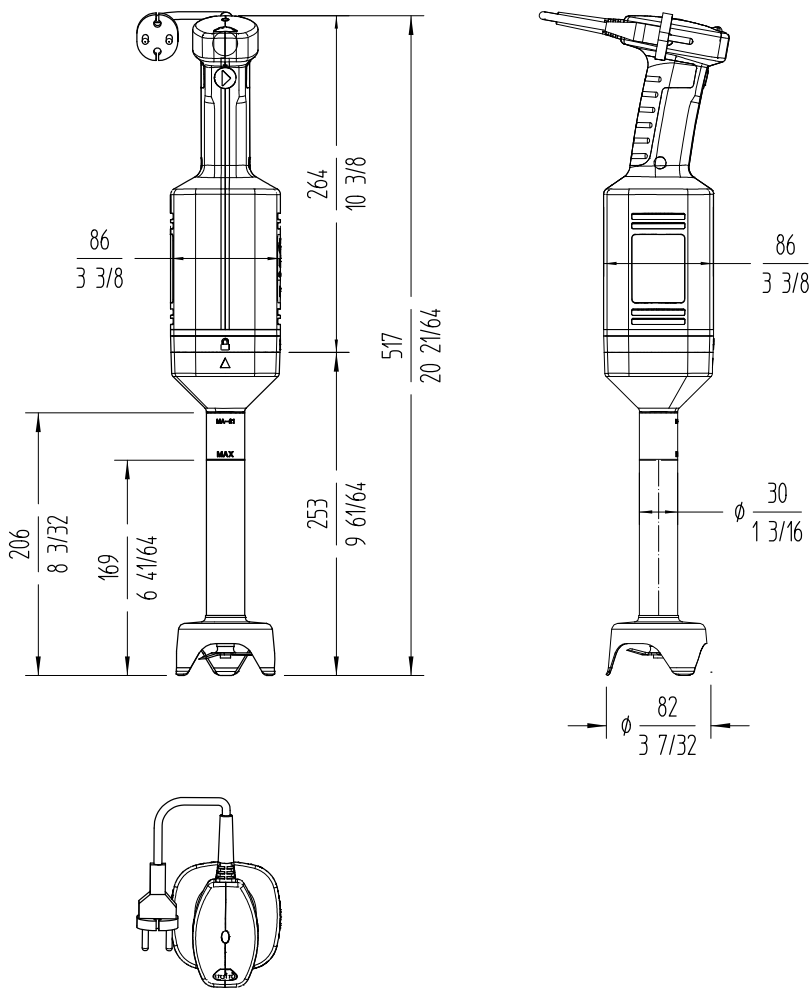

**sammic** | [www.sammic.com](http://www.sammic.com)  
Food Service Equipment Manufacturer

Polígono Basarte, 1.  
20720 Azkoitia, Spain

phone +34 943 15 72 36  
[sales@sammic.com](mailto:sales@sammic.com)



Project	Date
Item	Qty
Approved	

product sheet  
updated 03/02/2025